

PRIVACY ULTIMATE TILE /STONE UNDERLAY

PREMIUM FLOOR SOUNDPROOFING

FLOOR UNDERLAYMENT THAT WILL
IMPROVE IIC AND STC RATINGS

EASY INSTALL WITH APPROVED ADHESIVE

GREEN PRODUCT, MADE FROM 93% POST-
CONSUMER RECYCLED CONTENT

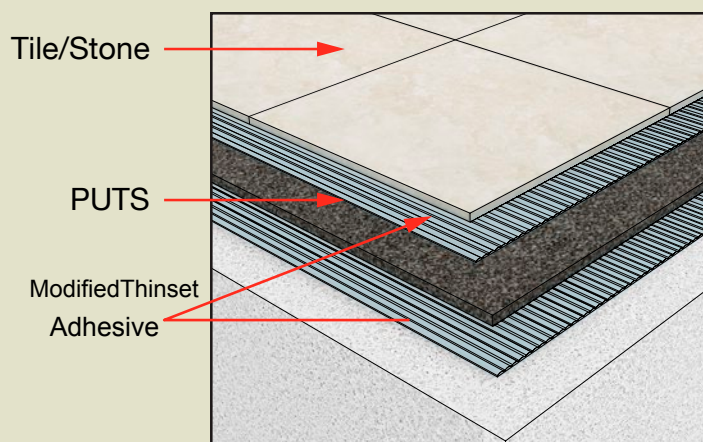

Privacy Ultimate Tile/Stone Underlay™ is applied with urethane adhesive. Finished floor is installed directly on the underlay with modified thinset- no CMU required. Flash with adhesive before setting tile.

Simple to install product for all stone and tile floors, that will meet IIC requirements. Floor Score Certified, eligible for LEED points, and approved for use in all commercial or residential projects.



SOUND [ISOLATION] COMPANY

Soundproofing Made Simple

(888) 666-5090 | Fax: (704) 504-1115
info@soundisolationcompany.com
www.soundisolationcompany.com



Privacy Ultimate Tile/Stone Underlay™

Introducing Privacy Ultimate Tile/Stone Underlay™, the most effective and longest performing underlayment for use under hard floor coverings. Privacy Ultimate Tile/Stone Underlay™ can be used over any sub floor to create truly measurable footstep noise reduction. By installing a resilient layer directly below ceramic and stone floors, the actual vibration from footsteps is captured before it reaches the structure.

Privacy Ultimate Tile/Stone Underlay™ will not absorb water, preventing rot, mold, mildew and shrinkage. PTSU requires no concrete backerboard, saving time and money.

Among the many benefits derived from this truly remarkable product:

- ▶ You will get a higher IIC Rating (footstep blocking)
- ▶ You will get a higher STC Rating (sound blocking)
- ▶ Finished floor will feel softer under foot
- ▶ Requires no mechanical fasteners or tape

**Solve your noise problem. Call now
to get it right the first time 888-666-5090**

With Sound Isolation Company you will get the help you need: expert design, product selection and installation instruction. We have the

PRIVACY ULTIMATE TILE/STONE UNDERLAY™ INSTALLATION GUIDE

Subfloor must be plywood or concrete, not OSB. Privacy Eco Urethane Adhesive is required to install underlay

- 1 Install Privacy Perimeter Isolation Strip™ along all walls and any protrusions, flush to floor and tall enough to meet with finished floor

- 2 Create chalk line at center of room and install first section of PUTS using urethane adhesive with factory edges butted together; do not overlap seams. Trimming takes place at walls. Apply only enough Privacy Adhesive to cover area that can be worked in 20 minutes.

Use 50 lb. roller to insure a complete bond. Roll in both directions.

- 3 **Prior to installing finished floor, apply a flash coat of thinset to underlay and allow to dry completely. Flexible grout is required to complete the installation**

- 4 Do not trim perimeter gasket until tile floor has been completely installed. Trim level with with tile and caulk at entire perimeter after base is installed.

PUU can be used over radiant heat systems, or below min. 1" thick pour LWC

Roll Sizes * denotes in stock

*3mm	4' x 40'	52 lbs
*5mm	4' x 30'	90 lbs
*10mm	4' x 15'	90 lbs
*12mm	4' x 15'	108 lbs

DISCLAIMER: These application notes represent generally accepted procedures for successful installation. Sound Isolation Company reserves the right to alter these suggestions and encourages contact with the factory or its representatives to review any possible modification to these application notes prior to commencing installation.

PRIVACY ULTIMATE TILE/STONE UNDERLAY™ is a trademark of Sound Isolation Company™

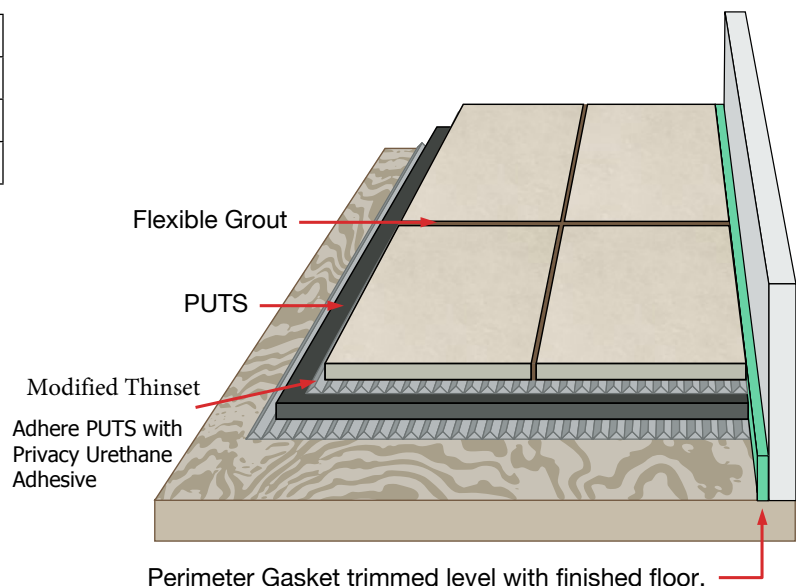
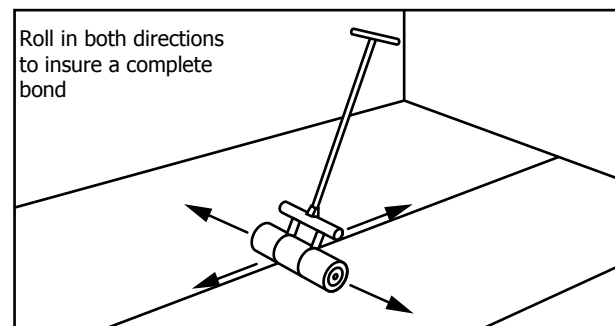
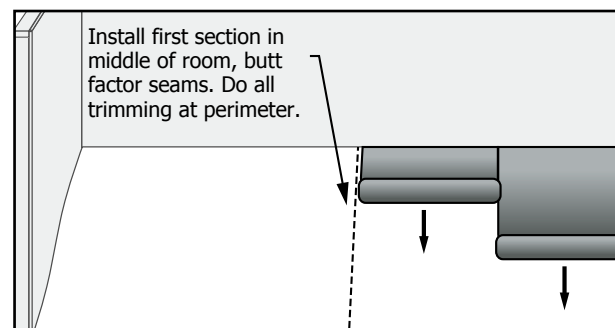
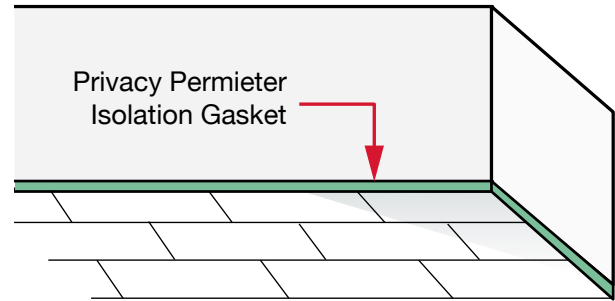

PRIVACY ULTIMATE UNDERLAY™

Privacy Ultimate Underlay™ is manufactured in the US from 92% recycled tire rubber. Backed by over 100 Independent Lab and Field Test, Eligible for up to 5 LEED Points, and Floor Score Certified, your project will benefit from the use of Privacy Ultimate Underlay™. Privacy Ultimate Underlay™ is available in thicknesses from 2-15mm and approved for use under ceramic tile, stone, laminate, hardwood, vinyl and carpet.

Distributed nationwide by Sound Isolation Company, Privacy Ultimate Underlay™ will provide measurable soundproofing every time it is used.

Call us today to discuss your project 888-666-5090



Floor Structure	Ceiling	Finish	PRIVACY ULTIMATE UNDERLAY™	IIC	STC
8" Concrete Slab	No	Bare	None	31	55
8" Concrete Slab	No	Wood	PUU-2	54	53
8" Concrete Slab	Yes	Wood	PUU-2	71	72
7" Concrete Slab	No	Tile	PUU-5	51-F	
7" Concrete Slab	No	Wood	PUU-5	58-F	
HAMBRO D500	Yes	Tile	PUU-15	58	61
HAMBRO D501	Yes	Wood	PUU-15	58	
HAMBRO D502	Yes	Wood	PUU-10	51	54
Open Web-Truss	Yes	Bare	None	44-F	
Open Web-Truss	Yes	Tile	PUU-6	53	55
Open Web-Truss	Yes	Tile	PUU-5	56	55
Steel Bar Joist	Yes	Tile	PUU-15	56-F	

Other test available upon request.

Product	Thickness	Roll Dimension	Weight/Roll	Type A Hardness (ASTM D2204)
PUU-2	2mm (1/8")	48"x75'	90 lbs.	40 durometer
PUU-3	3mm (1/8")	48"x25'	90 lbs.	40 durometer
PUU-5	5mm (1/4")	48"x30'	90 lbs.	40 durometer
PUU-10*	10mm (3/8")	48"x15'	90 lbs.	40 durometer
PUU-12	12mm (1/2")	48"x15'	90 lbs.	40 durometer
PUU-15	15mm (5/8")	48"x15'	90 lbs.	50 durometer



Soundproofing Made Simple®

2900 Westinghouse Blvd. Suite 106 ■ Charlotte, NC 28273

Phone: (704) 504-1127 ■ Toll Free (888) 666-5090 ■ Fax (704) 504-1115 ■ www.soundisolationcompany.com



PRIVACY PEEL AND STICK UNDERLAYMENT

EASY INSTALL SOUNDPROOFING
TILE AND STONE FLOORS

FAST AND EASY INSTALLATION IN HOURS
SET TILE THE SAME DAY, SAVING TIME
WILL MEET MULTI-FAMILY IIC CODE

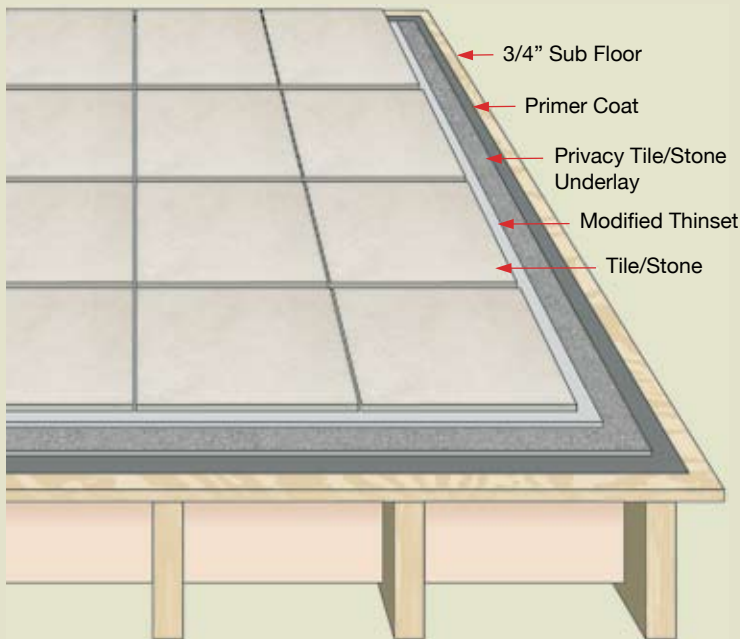

There are no special tools or adhesives required, your tile/stone is applied directly to Privacy Tile/Stone Underlay with latex modified thinset.

FOUR EASY STEPS

- 1) Prime Existing Sub Floor
- 2) Peel and Stick
- 3) Roll with 50 lb Carpet Roller
- 4) Install Flooring

Soundproofing Underlayment for Stone and Tile Floors

Sound Isolation Company introduces Privacy Tile/Stone Underlayment, the most effective and longest performing underlayment for use under hard floor coverings. Privacy Tile/Stone Underlayment can be used over any sub floor to create truly measurable footstep noise reduction. By creating a resilient layer directly below hard floors material, the actual vibration from footsteps is captured at the place where it occurs.

Privacy Tile/Stone underlay has been treated to prevent mold and mildew. It will not absorb water preventing rot and shrinkage, and requires no backerboard, saving time and money. With a peel & stick adhesive already in place, the product installs up to 4 times faster than traditional concrete board, and provides a bonded crack prevention system.

Among the many benefits derived from this truly remarkable product:

- ▶ You will get a higher IIC Rating (footstep blocking)
- ▶ Up to 25 times lighter than 1/4" backerboard
- ▶ Cuts easily with a utility knife
- ▶ Requires no mechanical fasteners or tape
- ▶ Simple installation with peel & stick adhesive

In stock and ready to ship today, call now to solve your floor soundproofing problem, 888-666-5090

With Sound Isolation Company you will get the help you need: expert design, product selection and installation instruction. We have the experience you need for a partnership that will work.

SOUND [ISOLATION] COMPANY

2900 WESTINGHOUSE BLVD. SUITE 106
CHARLOTTE, NC 28273
704 / 504 / 1127 PH
704 / 504 / 1115 FX
888 / 666 / 5090 TOLL FREE
WWW.SOUNDISOLATIONCOMPANY.COM

www.soundisolationcompany.com



Privacy Floor Underlayment for Tile/Stone Systems

- Installs up to 4 times faster with optional peel & stick
- Mortar locks in to form a bonded crack prevention system
- Sound reduction for both IIC and ambient noise
- Outperforms cork, at a lower installed cost

Effective Synthetic Cork Sound Reducing Underlayment For All Tile/Stone Floors

Privacy Tile/Stone Underlay is a truly forward thinking choice for your project. Unlike underlayments for gypcrete, which require carefully and costly installed perimeter isolation tape, Privacy Tile/Stone Underlay is installed directly on the sub floor, below the Tile. This is a more reliable method, noise is absorbed at the point of impact, and the installation has less potential pitfalls.

There are no special tools or adhesives required; your finished floor is applied directly to our product with latex modified thinset. Ease of installation, reasonable cost, and immediate availability all make Privacy Tile/Stone Underlay an automatic winner.

SOUNDPROOFING ACCESSORIES

Floor Primer
Acoustical Caulk
Foil Seam Tape

Privacy Tile/Stone Underlay on Wood

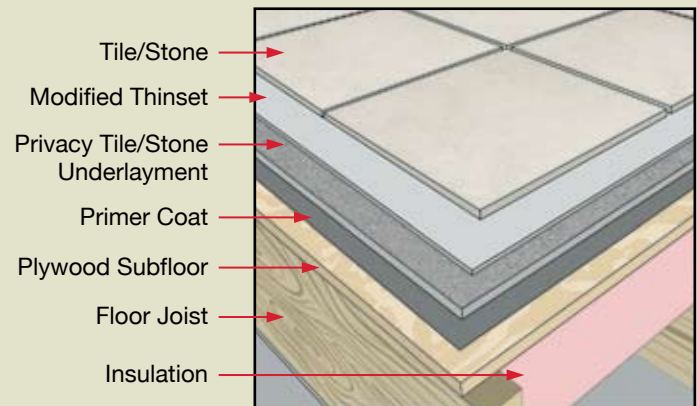

Privacy Tile/Stone Underlay on Concrete

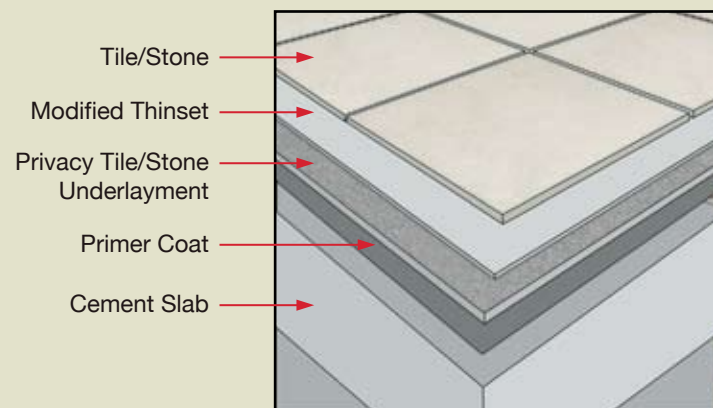

Specifications

Underlayment	3mm	5mm	12mm
Peel & Stick	Yes	Yes	No
Roll Length	4'x100'	4'x75'	4'x30'
Roll Weight (Total)	21.3 lbs.	25.4 lbs.	25 lbs.
Roll Diameter	13.5" (34.3 cm)	15" (38 cm)	15.5" (39.4 cm)
TCA Robinson Test	Light Commercial		Residential
R Value	.8	1.5	3.75
Water Absorption	.008 g/cm ²		
Flame Spread Smoke Development	Class A 15/55		
Δ IIC Improvement	16	20	23

* 3rd party field testing has shown that 3/16" Privacy Tile/Stone Underlay performs equally to 1/2" cork underlay, at half the price, and at a lowered installed cost.

PRIVACY TILE AND STONE UNDERLAY FOR SETTING TILE AND STONE



AREAS OF USE

Interior and exterior applications
Concrete, mortar beds, masonry
Lightweight concrete and/or air
entrained concrete
Primed gypsum underlayment
(minimum 2000 PSI cured)
Post-tension concrete
Exterior Grade Plywood
Primed OSB
Exterior decks
Ceramic tile
Resilient flooring
Cutback adhesive
Radiant heating systems
3 mm and 5 mm light
commercial, 12 mm residential

- Set tile and stone over any acceptable subfloor
- Up to 4 times faster to install than 1/4" backerboard – optional peel & stick version
- Up to 25 times lighter than 1/4" backerboard
- Cuts easily with a utility knife
- Mortar locks into form a bonded crack prevention system
- No mechanical fasteners or tape needed
- High and reliable impact sound reduction
- Eligible for a lifetime warranty

USES

The mat was specially designed so that the mortar locks in, creating a bonded crack prevention system for subfloor movement up to 1/4". This bonded system will withstand repeated stress and still maintain its tenacious bond. It is a superior alternative to cork underlayments because it is mold and mildew resistant and will not rot, shrink, or absorb water. T/S Underlay has SoundGard Technology and therefore offers high and credible impact sound reduction. Use T/S Underlay with other Custom® materials to qualify for a lifetime warranty.

USES – TILE TYPES

- Ceramic tile, all types including impervious porcelain
- Natural stone
- Precast terrazzo tile

LIMITATIONS

- Do not bond tile directly to hardwood, Luan plywood, particle board, parquet, cushion or sponge-back vinyl flooring, metal, fiberglass or plastic.
- Do not apply at temperatures below 50° F (10° C).
- Do not use as a wear surface. Mat must be covered with tile or wood flooring.
- Not for controlling vertical movement cracks or cracks greater than 1/4" (6 mm).
- When setting dimensional stone larger than 12" x 12" (30 x 30 cm) contact Technical Services for recommendations regarding subfloor deflection requirements.

Soundproofing Made Simple®

2900 WESTINGHOUSE BLVD SUITE 106
CHARLOTTE, NC 28273
704 / 504 / 1127 PH
704 / 504 / 1115 FX
888 / 666 / 5090 TOLL FREE
WWW.SOUNDISOLATIONCOMPANY.COM

SURFACE PREPARATION

Surfaces must be structurally sound, clean, dry and free from grease, oil, dirt, curing compounds, sealers, adhesives or any other contaminants that would prevent a good bond. Glossy or painted surfaces must be sanded, stripped and cleaned of waxes, dirt or any contaminants.

WOOD SUBSTRATES:

Plywood flooring including those under resilient flooring must be structurally sound, built to industry standards, and deflection should not exceed L/360.

Detailed wood subfloor minimum requirements as follows:

ITEM CODE	16" o.j.	19.2" o.j.	24" o.j.
3mm	3/4"	3/4" + 3/8"	3/4" + 3/8"
3mm PSA	5/8" + 3/8"	3/4" + 3/8"	3/4" + 3/8"
5mm	5/8"	3/4"	3/4" + 3/8"
5mm PSA	5/8"	3/4"	3/4" + 3/8"

PSA=Peel & Stick Application

EXISTING CERAMIC TILE, RESILIENT FLOORING OR PLASTIC LAMINATES:

Resilient flooring or plastic laminates must be well bonded, clean and free of all contaminants. Roughen the surface by sanding or scarifying, rinse and allow to dry. Do not sand flooring containing asbestos. For existing well-bonded ceramic tile, mechanically abrade with carborundum stone. Rinse and allow to dry. When sanding we recommend the use of an approved respirator.

BONDING MATERIALS – NON PEEL & STICK APPLICATION:

T/S Underlay can be bonded with a Custom® polymer-modified mortar meeting ANSI A118.4 or A118.11. Apply with a 3/16" x 1/4" (5 x 6 mm) V-notch trowel for 3 mm and 5 mm or use a 1/4" x 1/4" x 1/4" (6 x 6 x 6 mm) square-notch trowel for 12 mm. Apply only enough mortar as can be covered with T/S Underlay within 20 - 30 minutes. The thin-set should remain tacky to the touch and should not be allowed to skin over before T/S Underlay is set and pressed into place. As a second alternative, OmniGrip® Maximum Strength Adhesive or ReliaBond® Ceramic Tile Adhesive can be used to bond T/S Underlay to the substrate.

BONDING MATERIALS – PEEL & STICK APPLICATION:

For proper adhesion and optimal bond, prime the substrate with Custom's Peel & Stick Primer.

CUTBACK ADHESIVE OVER CONCRETE:

Adhesive layers must be removed as they reduce mortar bond strength to cement surfaces. Use extreme caution as adhesives may contain asbestos fibers. Do not sand or grind adhesive residue, as harmful dust may result. Never use adhesive removers or solvents, as they soften the adhesive and may cause it to penetrate into the concrete. Adhesive residue must be wet-scraped to the finished surface of the concrete, leaving only the transparent staining from the glue. Do a test bond area first, to determine desirable results. Refer to the RFCI Pamphlet, "Recommended Work Practices for Removal of Resilient Floor Coverings" for further information.

APPLICATION

BASIC PEEL & STICK APPLICATION:

Pre-application tip – In cold weather the peel & stick adhesive can be warmed up prior to application to soften the adhesive and make it more pliable and sticky.

First apply Custom's Peel & Stick Primer with a paint brush, short nap roller, or a soft push broom. Apply an even coat (5 - 10 mils) and allow to dry until tacky to the touch, about 30 - 45 minutes. When the primer does not transfer to your finger, the surface is ready for application. Unroll the mat while the release sheet is still attached and position it over the area to be treated and cut to appropriate length. Roll up half of the cut mat leaving the other half still in position. Cut release sheet from the rolled up portion and pull it towards you exposing and unrolling the self-stick portion of the mat. Re-roll the unrolled portion of the mat and follow the same procedure. Immediately roll the mat using a 30 - 50 lb. (13 - 26 kg) roller, or use a hand roller applying 30 - 50 lbs. (13 - 26 kg) of pressure, to ensure proper adhesive transfer. Air pockets and wrinkles should be slit and smoothed with a roller or the flat side of a trowel. Align subsequent sheets and butt join the seams tightly but do not overlap them. Sound Control Application:

Before application, first cut 3" (7.6 cm) wide strips of T/S Underlay and bond them (using a bonding material above) to the wall perimeter of the entire subfloor, as well as around the perimeter of any protrusions, in order to isolate or break the vibration transmission path between the floor and the wall. Assume that the walls you are butting up against are not square. Using a chalk line, create a starting point for an edge of the material to follow. Trim the ends of each section to exact dimensions to fit the surface area to be covered (e.g., joints with walls, etc.).

TILE APPLICATION:

Apply tile with a Custom polymer-modified mortar meeting ANSI A118.4 or A118.11 standards. It is recommended to key-in/burn-in a thin layer of thin-set into the surface of T/S Underlay as a first step to tiling.

ALTERNATE USAGE

FLOATING FLOOR SYSTEMS

(LAMINATE OR ENGINEERED WOOD):

Tile and Stone Underlay is approved for use under floating floor systems. Follow instructions above for bonding T/S Underlay to subfloor, then follow floor manufacturer's instructions for installation of the floor.

Hardwood:

Tile and Stone Underlay is approved for use under hardwood floor systems.

After bonding Tile and Stone Underlay to the subfloor (see basic instructions).

1a: Consult with the wood adhesive manufacturer for compatibility with T/S Underlay. - or -

1b: Apply a full, minimum 1/16" (1.6 mm) skimcoat of either Custom's Skim Coat & Patch or SpeedFinish™ Patching & Finishing Compound to the top. Allow the skimcoat to cure, then bond the hardwood to the cementitious surface following manufacturer's instructions.

TECHNICAL DATA

	T/S Underlay 3	T/S Underlay 5	T/S Underlay 12
Underlayment thickness	3 mm	5 mm	12 mm
Peel & stick	Yes	Yes	No available
Roll Dimensions	4' x 100'	4' x 75'	4' x 30'
Roll weight per sq. ft.	<.1	<.1	.2
Roll weight	21.3 lbs.	25.4 lbs.	25 lbs.
Roll diameter	13.5" (34.3 cm)	15" (38 cm)	15.5" (39.4 cm)
TCA Robinson Test	Light commercial	Light commercial	Residential commercial
R value	.8	1.5	3.75
Water absorption ASTM C272	.008 g/cm3	.008 g/cm3	.008 g/cm3
Flame Spread / Smoke Development	Class A 15/55	Class A 15/55	Class A 15/55
Δ IIC	16	20	23