

# Interactive Panel - Lighting System

Interactivity is the major buzzword in 21st century design; now there's a product that makes interactivity easy - Sensacell.



## Sensacell Introduces the New W3016-16-RGB Interactive Panel Lighting System

Sensacell's new modular interactive lighting panels combine LED lighting with motion sensing technology to create stunning interactive architectural lighting solutions.

Each modular 30 cm square wall panel contains the SensaSynth™ interactive lighting control engine that functions as a complete stand alone system; just add more modular panels to create surfaces of any size or shape. Combine designer surface materials with custom video and interactive behaviors to fully define your experience.

*The Sensacell module is a new type of light fixture, a light fixture that can be fully integrated within furniture, walls and displays.*

## Interactive furniture



## Residential furniture



## Counter tops

*An illuminated surface that responds to touch by changing color, brightness and pattern. It is a user controlled dynamic mood light.*

## Interactive furniture



**Interactive bench**



**Interactive dining table / conference table**

*It is a lighting system for creating dramatic and truly interactive architectural environments that meet today's modern design expectations.*

## Interactive walls



**Bars and hospitality**

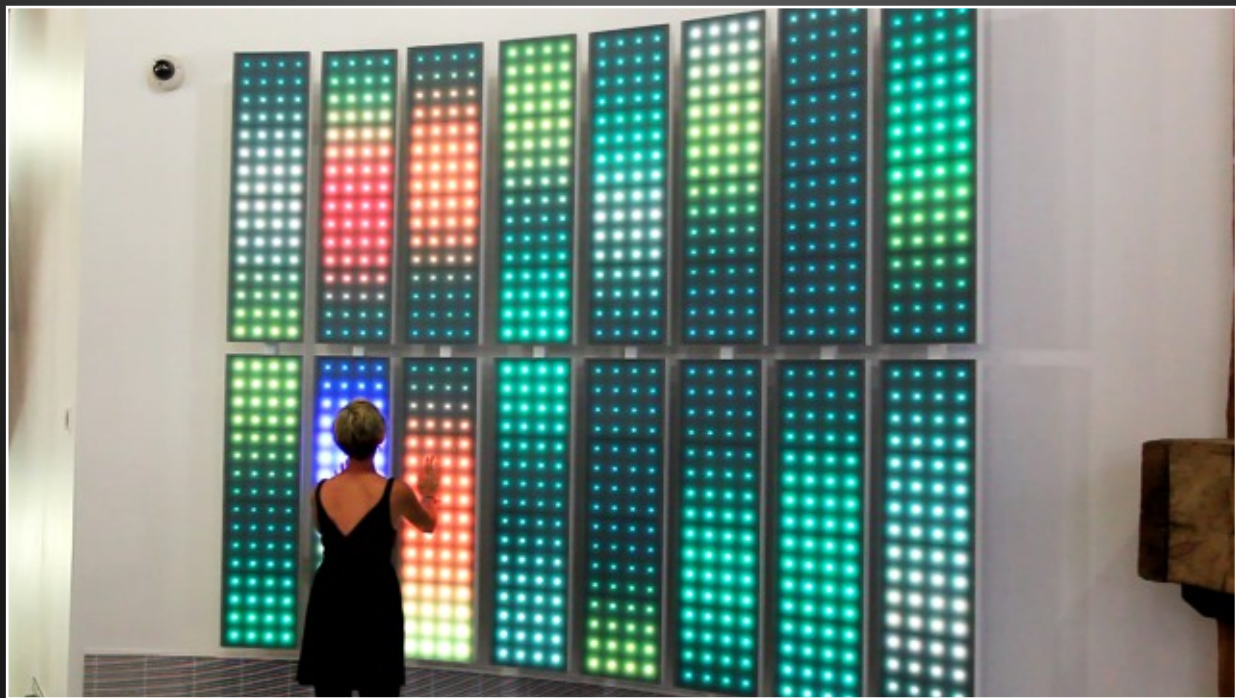

**Lobby installation**

## Interactive walls



**Nightclubs**



**Branding** - using a hi-resolution vinyl printed image on top of the modules

*An illuminated surface that responds to touch by changing color, brightness and pattern. It is a user controlled dynamic mood light.*

## Interactive floors



## Trade shows and showrooms



## Department store entrance

## Interactive floors

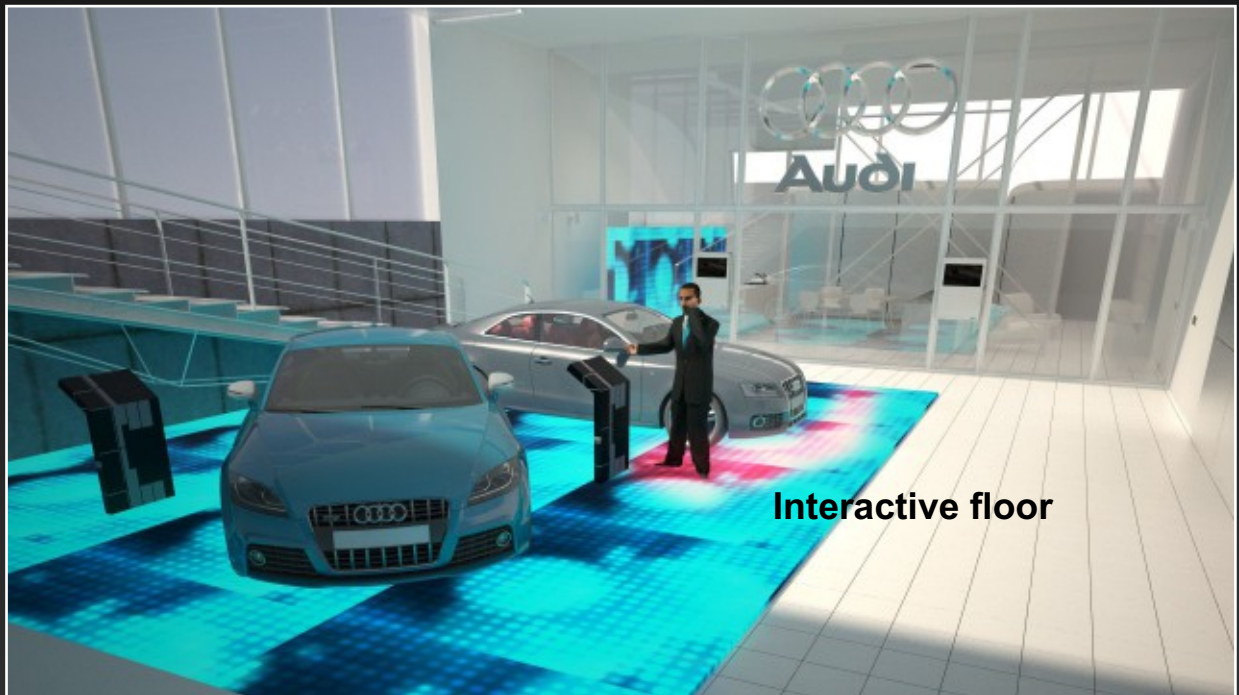

Showrooms and tradeshow

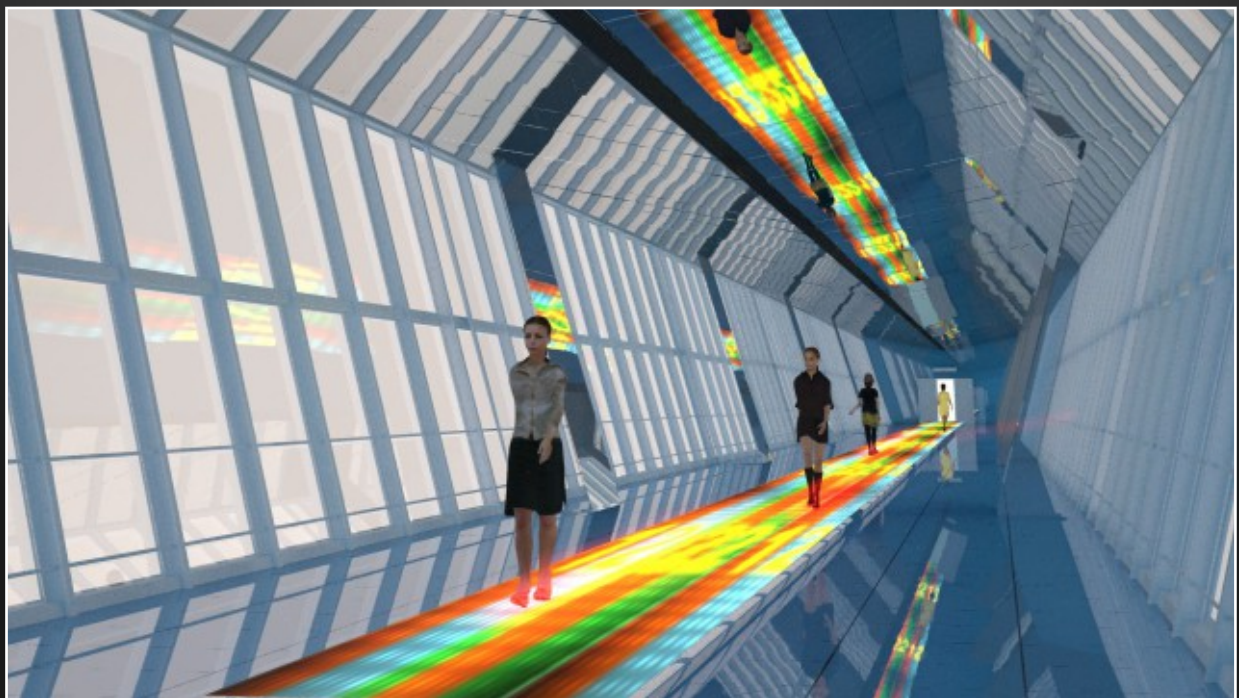

Fashion runways

*Systems can function as simple "stand alone" systems, requiring no external devices such as computers for simple and reliable installations.*

## Public space installations



**Public waiting areas**



**Department stores**



## Hospitality & Restaurants

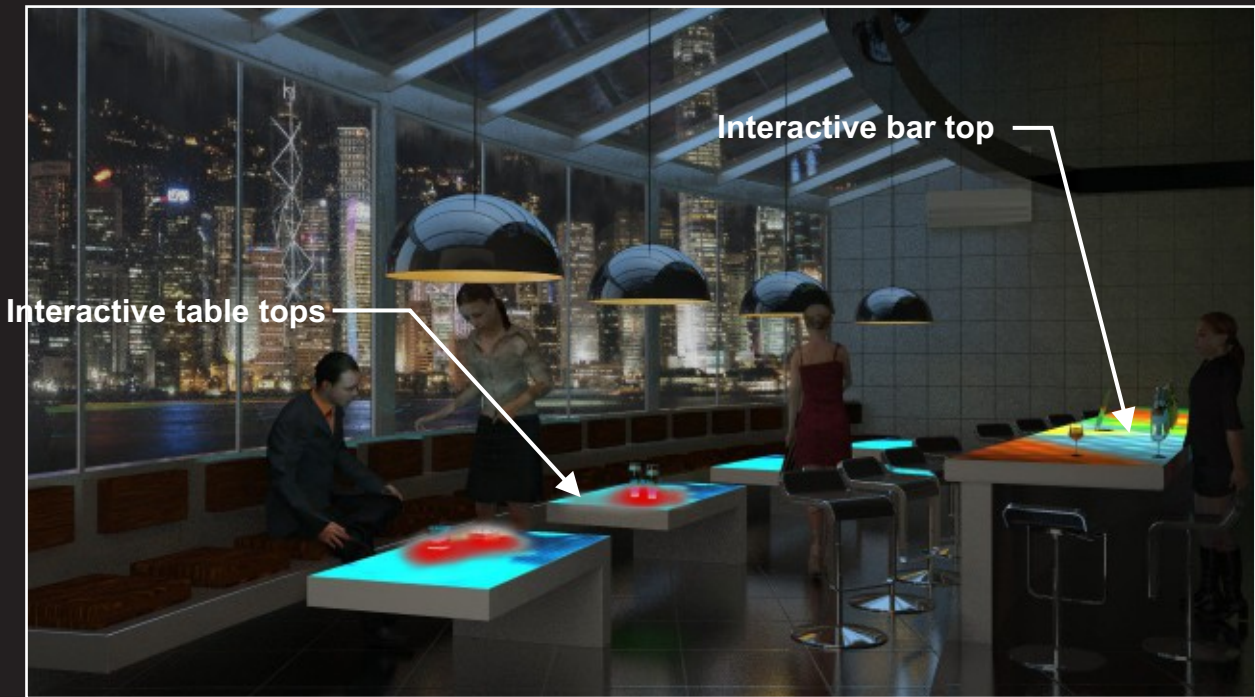

**Bars**

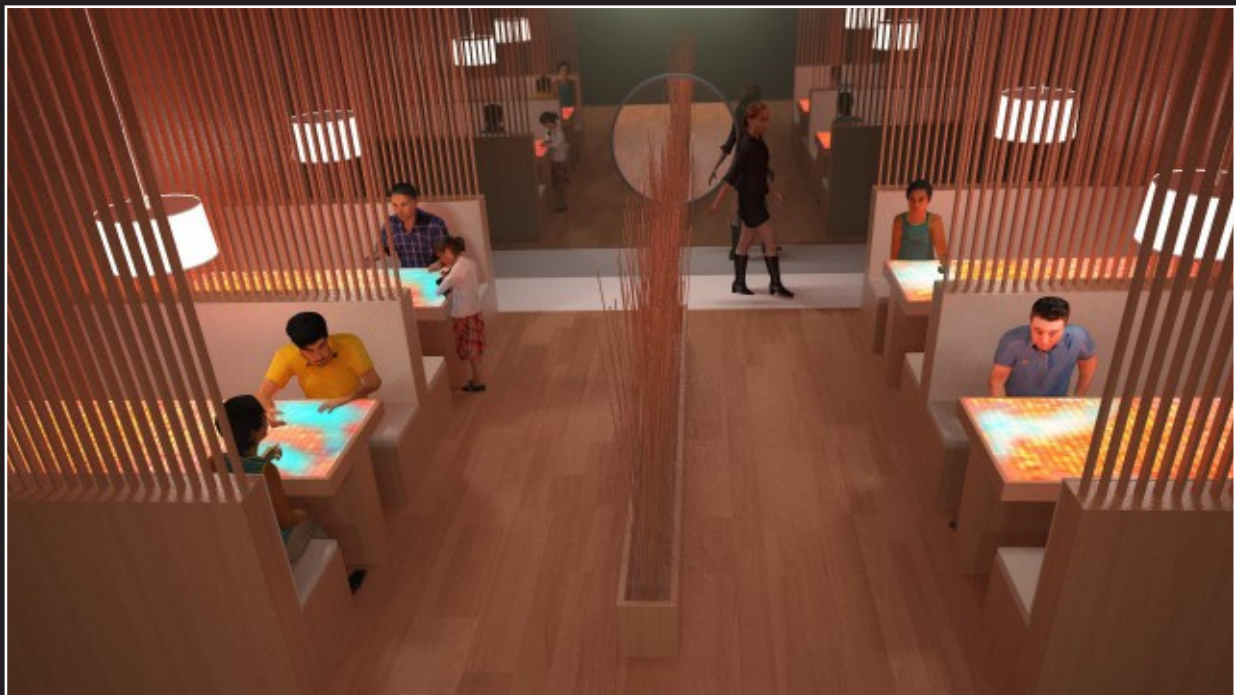

**Restaurants**

## Education & Play



**Daycare centers**



**Workout - Exergaming**

*True non-contact proximity sensing, with no moving parts ensures long life and high reliability. Sensacell modules are inherently protected by the surface materials employed in typical installations.*

## Retail & POP Display

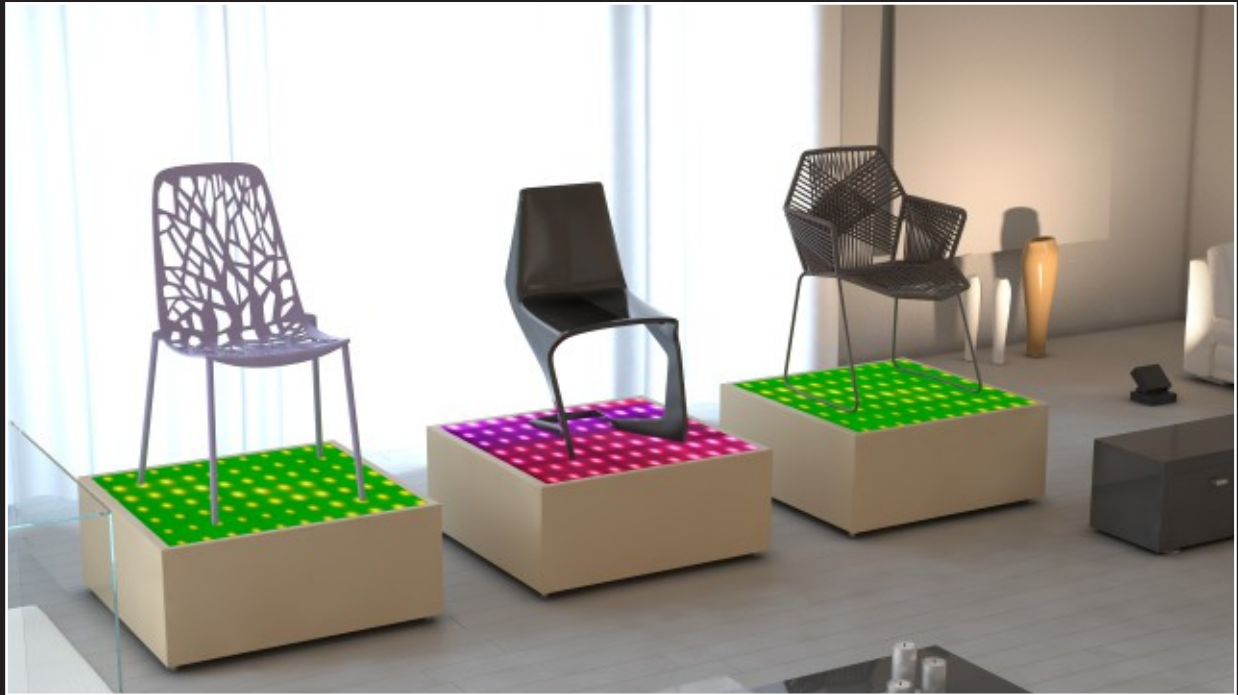

**Interactive product display**



**Makeup POP**

## SensaSynth™

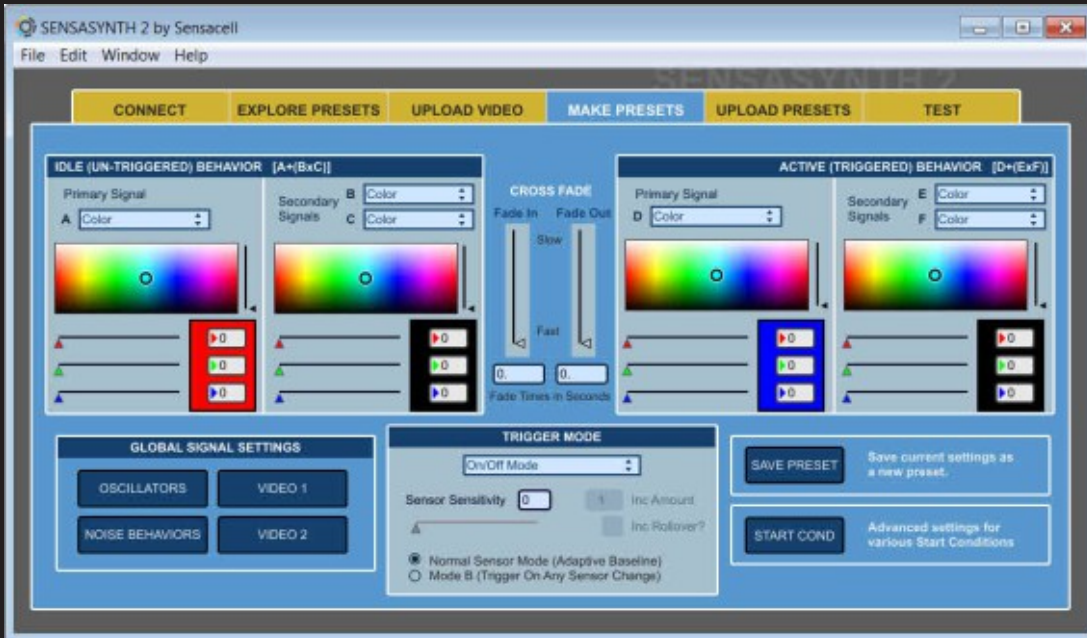

SensaSynth screen capture

### Creative Flexibility

The embedded SensaSynth™ interactive engine is the heart of the system, delivering a unique visual and tactile interactive experience. Each module is intelligent, when connected together they act as a unified system capable of displaying video, animations and dynamic mood lighting effects, all interactively controlled by embedded motion sensing technology that can sense directly through most designer

### Easy to Configure

The W3016-16-RGB module and the SensaSynth™ configuration software are designed to make developing sophisticated interactive lighting effects a snap. Simply upload video to the panel, develop and explore the interactive concept live on the panel, then upload for stand-alone operation.

## Mounting System & Surface Materials

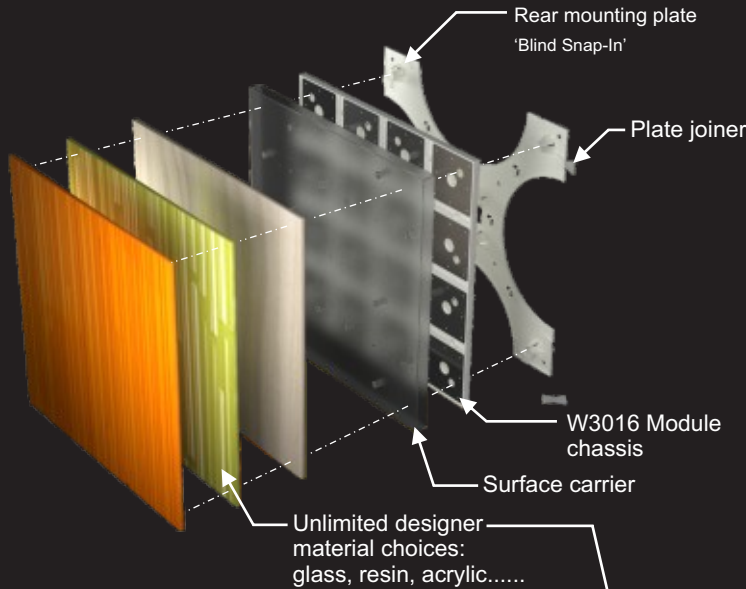

### Easy to Install

Installing and connecting the interactive modules is quick and painless using the snap-in mounting plate system.

Surface materials are installed to the front of each panel, the finished panel unit then snaps into the mounting plate, providing a clean finished look with all wiring and fasteners neatly concealed.



**Unlimited design materials**  
(Resin, Glass, Acrylic, Corian etc)

**Some recommended surface materials**

[www.3-form.com](http://www.3-form.com)



[www.dupont.com](http://www.dupont.com)

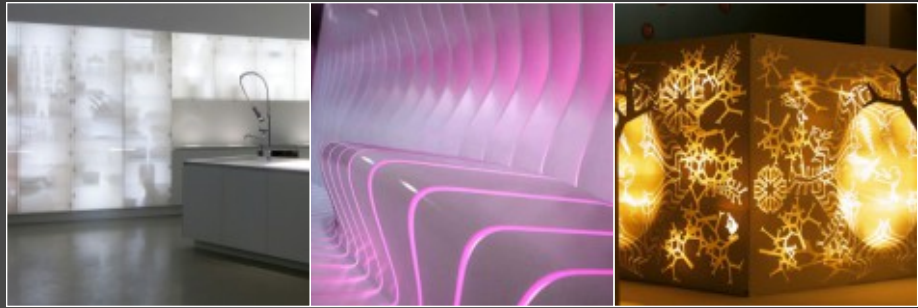

[www.panelite.us](http://www.panelite.us)



[www.vision-nex.com](http://www.vision-nex.com)

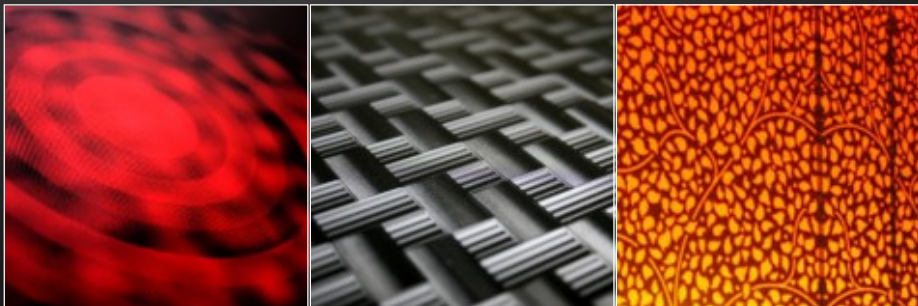

## Dimensions

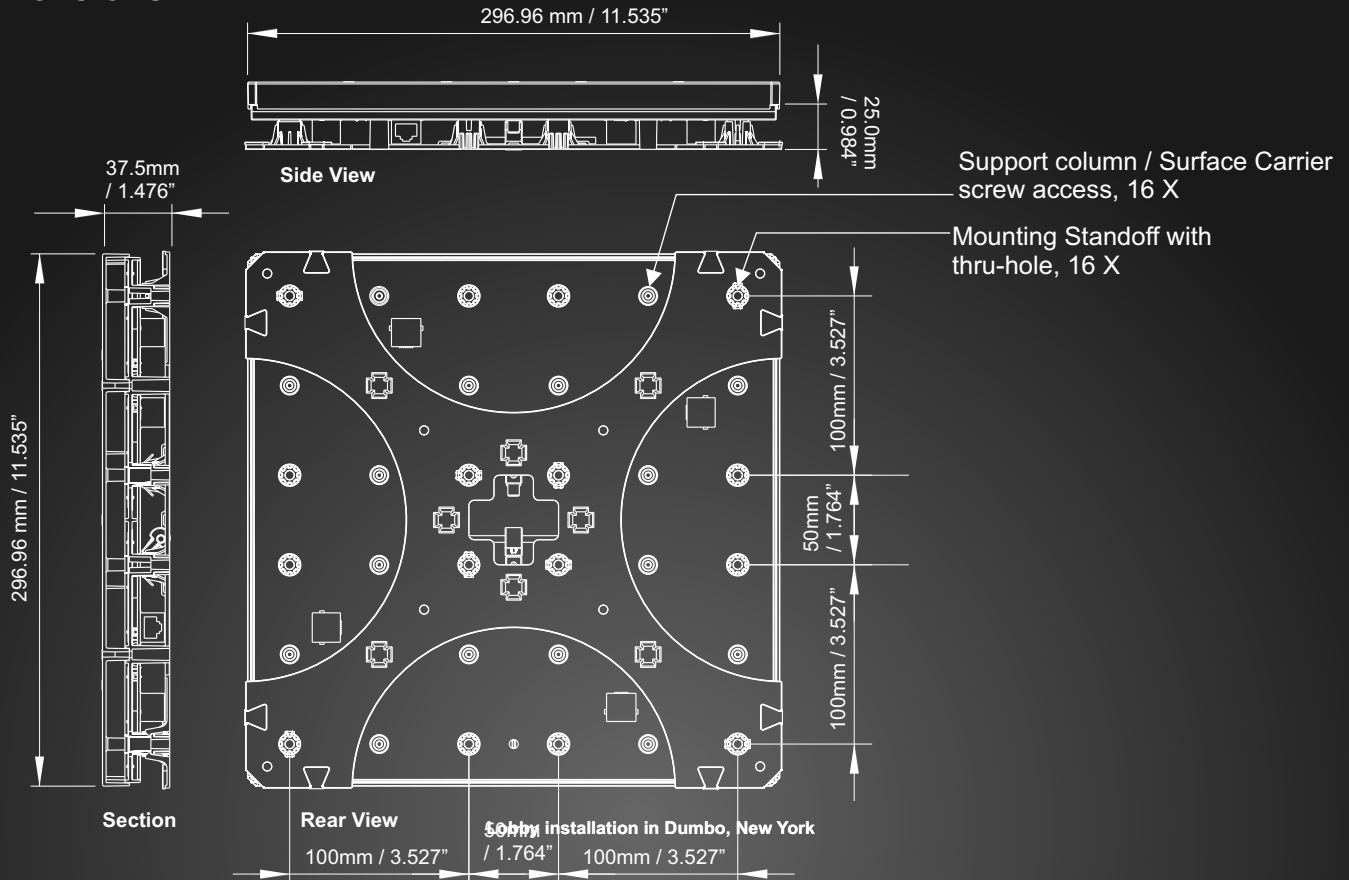

## Specifications

Module size	Module chassis + Rear mounting plate: 293.0mm x 293.0mm x 25.0mm / 11.535" x 11.535" x 0.984" Module chassis + Rear mounting plate + Surface carrier: 293.0mm x 293.0mm x 37.5mm / 11.535" x 11.535" x 1.476"
Weight	Module chassis: 811 grams / 28.61 ounces Rear mounting plate: 19.5 grams / 0.69 ounces Surface carrier: 240 grams / 8.46 ounces
Mounting pitch	300.0mm / 11.811" - module to module
LED pixel resolution	75.0mm / 2.952" pitch.
Construction	Injection molded plastic, PCB, Flame retardant to UL94V-0
Environmental range	Operating: -35 to 49 C / -30 to 120 F. Humidity: 5 to 90% - non condensing. Storage: -45 to 65 C / Storage: -50 to 150 F
Lighting	16 addressable pixels @ 75.0mm / 2.952" pitch. 16 digital gamma corrected PWM dimmers with 256 brightness levels
Sensors	16 x capacitive sensors, intelligent, adaptive. Sensing distance: 76mm / 3" Sensor response time: 100 milliseconds.

### Electrical

Power	Power 24 Volts DC, 0.2 A Max, 0.045 A Nominal Power input connector: 1/4" Faston terminals
Communications	RS-485 half-duplex 230,400 Baud